

# AF/Armaflex®

## Class 0 Self Seal

The World renowned flexible pipe insulation range with self adhesive closing for protection against condensation, pipe freezing and energy losses



- Available in a range of thicknesses and pipe diameters to meet Domestic Building Services Compliance Guide, Part L and BS 5422 recommendations
- Save up to £75 per annum off energy bills\*
- 25mm thick Armaflex pipe insulation on a 15mm bore copper pipe provides 8 hours frost protection at -6°C in accordance with BS 5422\*\* (lower temperatures will require greater insulation thickness)
- Easy to apply product with self-adhesive seal tubes and tapes

\*, \*\* See overleaf for details

**DBSCG**  
COMPLIANT

 **armacell**  
advanced insulation

# AF/Armaflex®

## Class 0 Self Seal

The Armaflex range is the most recognised brand of elastomeric pipe insulation, known throughout the World. Manufactured in the UK the high quality tubes and sheets have ODP and GWP ratings of zero and are dust and fibre free. The Armaflex Self Seal range is especially convenient for the insulation of domestic central heating and cold water pipes.

### TYPICAL SYSTEM APPLICATIONS

To supply the home with heating and hot and cold water, pipes run through floors, walls, ceilings and loft spaces. These pipes can lose up to 80% of their heat en-route and transmit annoying operating noises into the building, problems which can be mitigated by installing Armaflex.

Pipe insulation reduces these energy losses whilst also dampening the transmission of nuisance noise from pipework and preventing condensation on cold water pipes.



### ARMAFLEX SELF SEAL PRODUCT RANGE

- AF/Armaflex Class 0 Self Seal 2m length tubes are available in 9, 13, 19 and 25 mm wall thicknesses up to 89mm pipe diameter sizes

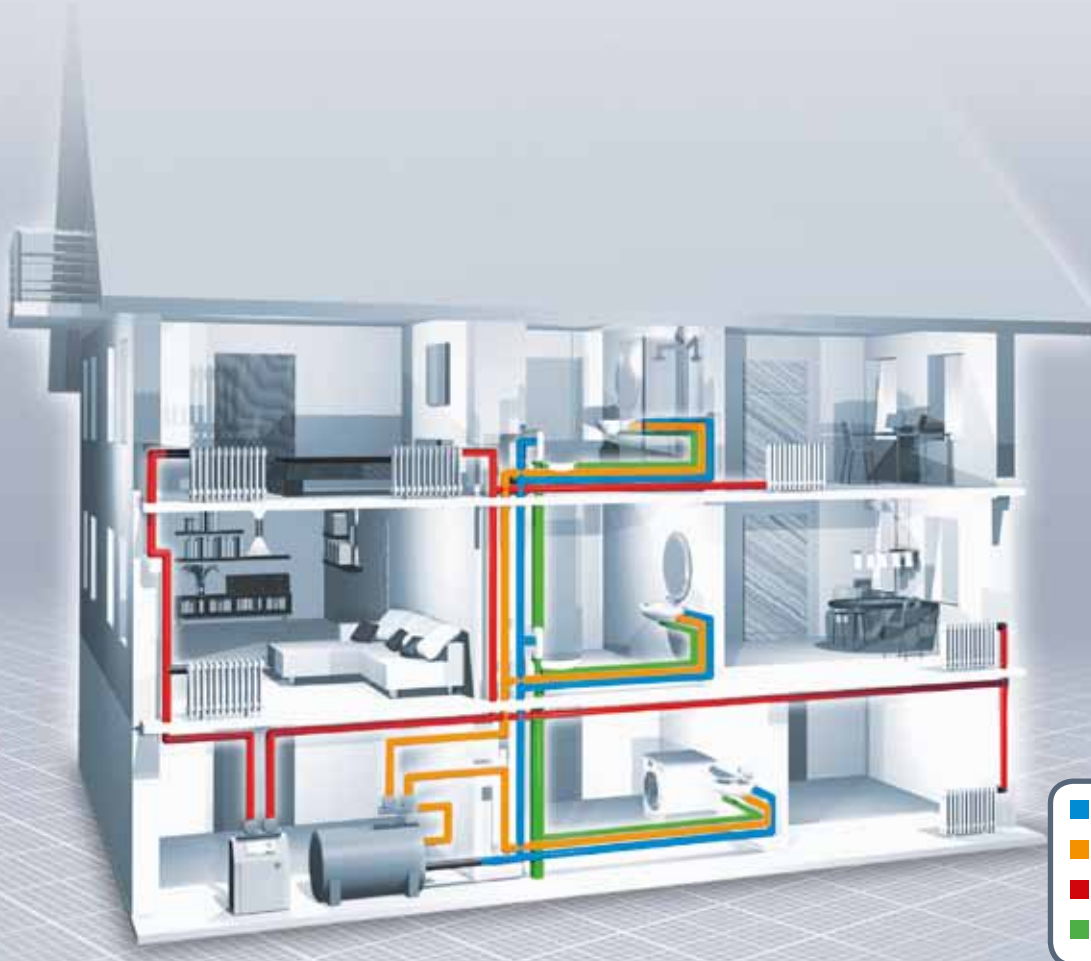

- = cold water pipes
- = domestic hot water pipes
- = heating system pipes
- = waste water pipes

The energy and frost protection calculation examples given on the front page are based on the following conditions:

\*Save up to £75 per annum based on 80m of 22mm diameter central heating pipework, insulated with 25mm thick AF/Armaflex Class 0, at ambient room temperature of 20°C, line temperature of 70°C, boiler efficiency of 85%, operating for 5 hours a day, 280 days per year with a gas unit price of £0.05 per kWh.

\*\*8 hours frost protection based on initial water temperature of 7°C

**Save energy and protect pipework against freezing and condensation**

energy savings up to 80%

Armaflex pipe insulation tape

closed-cell foam with low thermal conductivity

protect pipework from freezing and heat losses

**Your benefit:**

**AF/ARMAFLEX CLASS O SELF SEAL: Speed up your installation and save up to 30% on labour costs**

AF/Armaflex Class O Self Seal is a nitrile rubber pipe insulation product fully slit along each length with two strips of double sided self adhesive tape pre-applied to each open slit surface. Specially developed to provide insulation where fast, secure installation is required and ideal for applications where working space is restricted, AF/Armaflex Class O Self Seal is easily applied by fitting the insulation and peeling back the self adhesive tape. Fast and secure gluing of seams over the entire length of an installation is ensured, giving a professional finish and aesthetic appearance to the entire installation.



Air Conditioning



Heating



Plumbing

**Product range**

**AF/Armaflex Class O DBSCG Range**

**DBSCG**  
COMPLIANT

Pipe-Ø					Tube, length 2 m.			
Copper pipes Cu		Steel pipes Fe		Plastic pipes	DBSCG Compliant Range to meet Part L compliance requirements			
Outside Ø mm	Inch	DN mm	Outside Ø mm	Outside Ø mm	Code	Max. Permissible Heat loss [W/m]	Thickness [mm]	m/carton
15	¼	8	13.5	14	AF-CO-19X015-A	7.89	19	78
22	½	15	21.3		AF-CO-25X022-A	9.12	25	40
28	¾	20	26.9		AF-CO-25X028-A	10.07	25	32
35	1	25	33.7		AF-CO-25X035-A	11.08	25	24
42	1 ¼	32	42.4		AF-CO-25X042-A	12.19	25	24

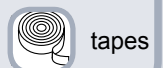

**Product range**

**AF/Armaflex Class O Frost Protection**

Pipe-Ø					Tube, length 2 m.			
Copper pipes Cu		Steel pipes Fe		Plastic pipes	Freezing time hours in accordance with BS5422 (min. 8 hours protection)			
Outside Ø mm	Inch	DN mm	Outside Ø mm	Outside Ø mm	Code	Freezing Time Hours	Thickness [mm]	m/carton
15	¼	8	13.5	14	AF-CO-25X015-A	8.1	25	48
22	½	15	21.3		AF-CO-25X022-A	15.5	25	40
28	¾	20	26.9		AF-CO-25X028-A	21.1	25	32
35	1	25	33.7		AF-CO-25X035-A	30.0	25	24
42	1 ¼	32	42.4		AF-CO-25X042-A	39.4	25	24

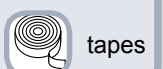



# AF/Armaflex®

## Class 0 Self Seal

### Technical data

**Material:** Elastomeric foam based on synthetic rubber. Flexible closed cell material with built-in Microban® antimicrobial protection.

**Applications:** Insulation/protection of pipes (heating system pipes, domestic hot and cold water pipes, air conditioning and refrigeration chilled pipework) and other heating and plumbing installations (incl. elbows, fittings, flanges, etc) to prevent heat losses and save energy. For high humidity conditions and all chilled and cold water applications Armaflex is the industry standard to prevent condensation and corrosion issues.

Property	Value/Assessment	Test Certificate* <sup>1</sup>	Supervision* <sup>2</sup>	Special remarks										
<b>Temperature range</b> Max. service temperature Min. service temperature	+110° C (+85° C when sheet or tape is glued to flat surfaces)* <sup>3</sup> -50° C	GB 5165 / GB 5164		Tested acc. to EN 14706, EN 14707 and EN 14304										
<b>Thermal conductivity* λ</b> at 0° C	≤ 0.034 W/(m · K)* λ = [34 + 0.1 · θ <sub>m</sub> + 0.0008 · θ <sub>m</sub> <sup>2</sup> ]/1000	D 4804 GB 5148		Tested acc. to DIN EN 12667 and EN ISO 8497										
<b>Reaction to fire</b>	<table border="1"> <tr> <td>Surface Spread of Flames</td> <td>Class 1</td> </tr> <tr> <td>Fire Propagation</td> <td>Total Index Performance (I) ≤ 12 Sub Index (i<sub>1</sub>) ≤ 6</td> </tr> <tr> <td>Fire Performance acc. to Building Regulations</td> <td>Class O</td> </tr> <tr> <td>Euroclass - sheets</td> <td>B-s3, d0</td> </tr> <tr> <td>Euroclass - tubes</td> <td>B<sub>L</sub>-s3, d0</td> </tr> </table>	Surface Spread of Flames	Class 1	Fire Propagation	Total Index Performance (I) ≤ 12 Sub Index (i <sub>1</sub> ) ≤ 6	Fire Performance acc. to Building Regulations	Class O	Euroclass - sheets	B-s3, d0	Euroclass - tubes	B <sub>L</sub> -s3, d0	GB 5151 & GB 5153  GB 5150 & GB 5152	● / ○	Surface spread of flame: tested according to BS 476 Part 7: 1997  Fire propagation: tested according to BS 476 Part 6: 1989  Classified according to 13501-1 Tested acc. to EN 13823 EN ISO 11925-2
Surface Spread of Flames	Class 1													
Fire Propagation	Total Index Performance (I) ≤ 12 Sub Index (i <sub>1</sub> ) ≤ 6													
Fire Performance acc. to Building Regulations	Class O													
Euroclass - sheets	B-s3, d0													
Euroclass - tubes	B <sub>L</sub> -s3, d0													
<b>Resistance to building materials</b>	resistant against commonly used building materials like concrete, lime, gypsum, cement													
<b>Dimensions &amp; tolerances</b>	In accordance with EN 14313, table 1	GB 5164 / GB 5165		Tested acc. to EN 822, EN 823, EN 13467										
<b>UV resistance</b>	Paint with Armafinish 99 when installed outdoors													

\*<sup>1</sup> Further technical specifications (test certificates, approvals etc.) can be delivered upon request, please quote certificate number.

\*<sup>2</sup> ● = Official supervision by independent institutes and/or test authorities ○ = regular in-factory quality monitoring according to prEN14304

\*<sup>3</sup> In case the insulation is glued with its whole surface directly onto the object and the surface temperature of the object exceeds +85°C, HT/Armaflex sheets (rolls) should be used.

### Armaflex Accessories



- **Adhesive Armaflex 520:** guarantees a reliable seal at tube butt joints and seams
- **Armaflex Cleaner:** for cleaning the surfaces to be joined and the tools used
- **Armafinish 99:** White or grey paint for protecting Armaflex from UV damage
- **Cutting sets:** 3 piece knife set with sharpening stone
- **Ceramic knife:** Cuts Armaflex without becoming dulled



### Installation hints

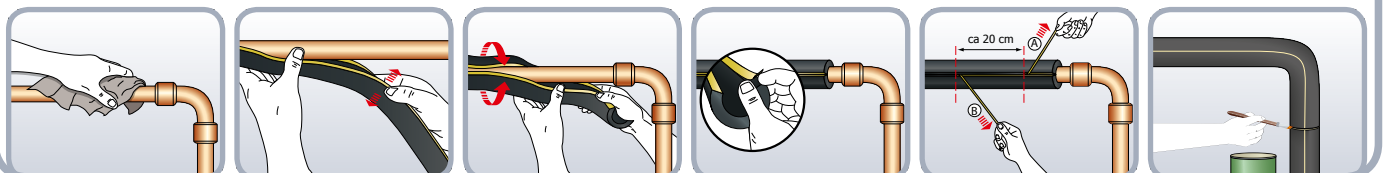

Clean all dust, dirt, oil and water from pipework using Armaflex Cleaner where necessary. Install Armaflex when ambient temperature is between +10 and +35°C. Open the pre-slit tube and fit over the pipe. Adjust to ensure the self-adhesive strips are easily accessible. Remove the white protection paper strips on both sides. Close

the slit seam and squeeze together with firm pressure, to ensure a permanent seal. The Armaflex can be pushed around long radius bends. Alternatively two piece elbows can be formed using the cutting template printed on all Armaflex boxes and seal using Armaflex 520 Adhesive\* (always cut along the flat side of tubes). The

use of a sharp ceramic cutting knife is recommended (Armaflex Cleaner available for cleaning adhesive from tools and Armaflex insulation). Seal all butt joints with Armaflex 520 Adhesive. Alternatively AF/Armaflex Class O tape can be used to seal joints on central heating pipework (not suitable to seal joints on cold applications).

\*Optimal evaporation time under normal conditions: 1 min. 30 sec.

All data and technical information are based on results achieved under typical application conditions. Recipients of this information should, in their own interest and responsibility, clarify with us whether or not the data and information apply to the intended application area. Installation instructions are available in our Armaflex installation manual. Please consult Customer Services before insulating stainless steels. Adhesive Armaflex 520 must be used to guarantee proper installation. Product not suitable for outdoor use without painting with Armafinish 99.

#### Armacell UK

Mars Street, Oldham, OL9 6LY · T +44 (0)161 287 7100  
www.armacell.com/uk · info@armacell.co.uk



© Armacell Enterprise GmbH



WE SUPPORT

Armaflex SS | PL | 20130913